

ELEVATE™ ORIGINAL

Imagine being able to change the height of a workstation as easily as you flip on a light switch. Work sitting or standing with a shelf height that ranges from 27" high to 53" high and moves 1.7"/second. Adjust the height to fit just about anyone. And with options that maximize your corner space and wrap around you, you're sure to find an Elevate Original that fits the way you work.



With a push of a button, Abigail can work sitting or standing whenever she wants.

PRODUCT SPECIFICATIONS

Shelves: Shelves are made of 1.25" thick, medium-density fiberboard with durable, seamless thermoplastic laminate. The front edge has a contoured, waterfall radius that's comfortable against your arms.

Legs and Tubes: 16 gauge steel with a baked-on, powder coat finish.

Casters: Single-wheel, heavy-duty 4" rubber Casters.

Electrical: Constructed with components that are UL recognized.

Colors: See Color Choices at the top of the following pages for available colors.

Warranty: Lifetime Warranty against manufacturing defects on the table; two-year warranty on legs and electrical system. Cords and plugs are not warranted.

ELEVATE ORIGINAL WORKSTATIONS

ELEVATE ORIGINAL SINGLE SURFACE TABLE



ELTB148SM-BK4 shown above.

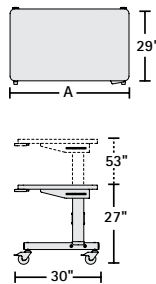

- Comes with 1 shelf (1.25" thick), 1 cable trough, 1 horizontal cross brace, 2 shelf support arms, 2 leg assemblies, 1 electric keypad for vertical shelf height adjustment, 2 base tubes (2.5" diameter), 2 cross tubes (1.75" diameter), 1 power cord (10' long), and 4 casters (4", locking).
- Weight capacity is 150 lbs. on the height-adjustable shelf and 100 lbs. on the base structure of the Table.
- Ships in two boxes.

PRODUCT	Width (A)	Weight (2 boxes)	Part#	Price
36" wide	36"	150 lbs. / 18 lbs.	ELTB136zz-BK4	\$2,379
48" wide	48"	160 lbs. / 25 lbs.	ELTB148zz-BK4	\$2,449
60" wide	60"	170 lbs. / 32 lbs.	ELTB160zz-BK4	\$2,569
72" wide	72"	180 lbs. / 42 lbs.	ELTB172zz-BK4	\$2,699

ELEVATE ORIGINAL ADJUSTA



ELTBAJ60SM-BK4 shown above.

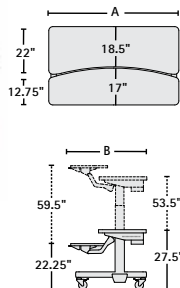

- Comes with one monitor shelf (1.25" thick), one keyboard shelf (1" thick), 1 cable trough, 1 horizontal cross brace, 2 shelf support arms, 2 leg assemblies, 1 electric keypad for monitor shelf height adjustment, 1 mechanism and paddle for manual keyboard shelf height adjustment, 2 base tubes (2.5" diameter), 2 cross tubes (1.75" diameter), 1 power cord (10' long), and four casters (4", locking).
- Weight capacity is 150 lbs. on the monitor shelf, up to 40 lbs. on the keyboard shelf, and up to 100 lbs. on the frame.
- Ships in two boxes.

PRODUCT	Width (A)	Depth (B)	Weight (2 boxes)	Part#	Price
48" wide	48"	36"	170 lbs. / 25 lbs.	ELTBAJ48zz-BK4	\$2,849
60" wide	60"	36"	180 lbs. / 32 lbs.	ELTBAJ60zz-BK4	\$3,199

ELEVATE ORIGINAL CORNER



ELTBSCM-BK4 shown above.

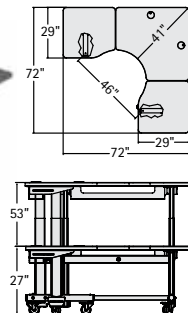

- Comes with 1 shelf (1.25" thick), 2 cable troughs, 2 horizontal cross braces, 2 shelf support arms, 1 corner support assembly, 4 leg assemblies, 1 electric keypad for vertical shelf height adjustment, 2 base tubes (2.5" diameter), 4 cross tubes (1.75" diameter), 1 power cord (10' long), and 6 casters (4", locking).
- Weight capacity is 300 lbs. of distributed weight, no more than 90 lbs. over a leg, and up to 100 lbs. on the base structure of the table.
- Ships in two boxes.

PRODUCT	Weight (2 boxes)	Part #	Price
Elevate Original Corner	210 lbs. / 160 lbs.	ELTBCzz-BK4	\$4,929



ELEVATE ORIGINAL PACKAGES

To make ordering Elevate Original tables a little easier, we've gathered popular combinations of Elevate Original tables and accessories that are targeted to specific healthcare imaging configurations. But feel free to think outside the box and use these packages wherever they fit your needs!

ELEVATE ORIGINAL 2+1 PACKAGE



- For two 3MP displays and one system display, and one CPU. Additional arms and CPU holders sold separately.
- Comes with a 60" wide Single Surface Table, one dual monitor arm, one single-standard monitor arm and one CPU SideRack.
- Ships in five boxes.

PRODUCT	Weight	Part#	Price
Elevate Original 2+1 Package	255 lbs.	BELTB01SM-BK4	\$3,649.95

ELEVATE ORIGINAL 2+2 PACKAGE



- For two 3MP displays, two system display, and two CPUs. Additional arms and CPU holders sold separately.
- Comes with a 72" Single Surface Table, one dual monitor arm, two single-standard monitor arms and two CPU SideRacks with Casters.
- Ships in seven boxes.

PRODUCT	Weight	Part#	Price
Elevate Original 2+2 Package	267 lbs.	BELTB02SM-BK4	\$4,799.95

ELEVATE ORIGINAL LARGE DISPLAY PACKAGE



- For one 6MP display, one system display, and one CPU. Additional arms and CPU holders sold separately.
- Comes with a 60" wide Elevate Adjusta Table, one single-extra heavy-duty monitor arm, one single-standard monitor arm, and one CPU SideRack with Caster.
- Ships in five boxes.

PRODUCT	Weight	Part#	Price
Elevate Original Large Display Package	270 lbs.	BELTB03SM-BK4	\$4,149.95

COLOR CHOICES

Select your product colors from the following swatches. Replace "zz" with a 2-letter Metal Code and "xx" with a 2-letter Laminate Code.

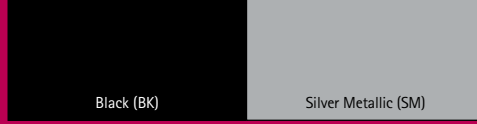

Metal Colors (zz)



Laminate Color (BK)

ELEVATE ORIGINAL ACCESSORIES

CPU SOLUTIONS

CPU Roll-out

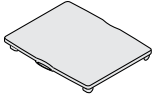

- These stand-alone shelves roll on 2" casters for easy access to your servers and CPUs.
- Has a weight capacity of 240 lbs. and extends 3" from the front of your Elevate Original Single Surface Table.

PRODUCT	Width	Depth	Height	Weight	Part #	Price
20" wide	20"	23"	3.75"	17 lbs.	CRS20BK	\$139.95

⚠ Not recommended for sit-down applications.

CPU Slide-out

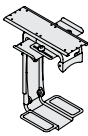

- Attach your CPU to the underside of your work surface. Rotate the CPU for easy access to the back.
- Insert your CPU into the adjustable cradle and tighten it down. The cradle pulls in and out on a 16" track and holds CPUs 3"-9.5" wide, 12-22" high.
- Has a weight capacity of 70 lbs. and is available in Black (BK) metal.
- Comes with 15-year warranty against manufacturing defects.
- Drill required for installation. **F**

PRODUCT	Weight	Part #	Price
CPU Slide-out	17 lbs.	347BK	\$119.95*

⚠ Does not work with Elevate Adjusta.

CPU SideRacks

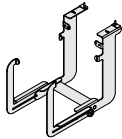

CPU SIDERACK,
SINGLE SURFACE TABLE
& ADJUSTA

- Save room on your work surface by mounting your CPU to the side of your Elevate Original.
- Installs on the outside of your Table on either the right or left side. Choose from the models below to find the style that fits.
- Available in Black (BK) or Silver Metallic (SM).

CPU SideRack, Single Surface Table & Adjusta

- Attaches to the side gusset on your Elevate Original Single Surface Table on the left or the right and goes up and down with the Table.
- Measure the width of your CPU, and add 3" to determine how far the SideRack will extend from the side of your Table.
- Has a weight capacity of 40 lbs.

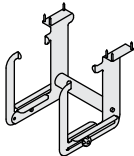

CPU SIDERACK,
CORNER & WRAP

CPU SideRack, Corner

- Installs flush with the edge of your Elevate Original Corner; the bottom of your CPU will be 16" below the top of the Elevate Original work surface.
- Measure the width of your CPU, and add 3" to determine how far the SideRack will extend from the side of your Table.
- Has a weight capacity of 40 lbs.
- The Elevate Original Corner is pre-drilled for this SideRack.

CPU SideRack with Caster

- Comes with its own 3" caster, so it's like a sidecar for your CPU. Lifts your CPU 5.5" above the floor. When used with the Elevate Original Corner, it accommodates CPUs up to 19" high.
- Adjusts to fit CPUs from 4.5"w to 10"w and attaches to the Base Tube.
- Has a weight capacity of 100 lbs.

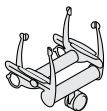

CPU SIDERACK W/ CASTER

PRODUCT	Width	Depth	Height	Weight	Part #	Price
CPU SideRack, Single Surface Table & Adjusta	4.5-10"	10"	14.5"	12 lbs.	760zz	\$189.95
CPU SideRack, Corner	4.5-10"	10"	14.5"	12 lbs.	758zz	\$159.95
CPU SideRack with Caster	4.5-10"	10"	11.5"	9 lbs.	566zz	\$174.95

CUP HOLDER



- Precision engineered and field tested, this finely tuned apparatus will give you years of cup holding satisfaction.
- At 2" deep, it holds up to 3.5" diameter cup and attaches to the edge of your Elevate Original with a C-clamp.
- Available in Black (BK) or Silver Metallic (SM).

PRODUCT	Height	Width	Depth	Weight	Part #	Price
Cup Holder	2"	4.5"	2"	2 lbs.	465zz	\$29.95

DOCUMENT STAND

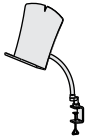

- Comes with steel stand, 10" gooseneck and C-clamp and attaches onto the edge of any shelf.
- The lip of the steel stand is 2" deep and .5" high to securely hold your documents, a book, or a multi-line phone.
- Available in Black (BK).

PRODUCT	Width	Height	Weight	Part #	Price
Document Stand	14.25"	11"	4 lbs.	440BK	\$139.95

DRAWER SOLUTIONS

Drill required for installation. ⚠ Except for FileAround, all Drawers attach to the underside of Shelves. Available in Black (BK) or Silver Metallic (SM) unless otherwise noted.

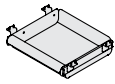

Drawer – Small 3" h

- This 3" high locking metal drawer features full-extension glides, making it easy to reach everything in your drawer.
- Interior dimensions are 12.75" w x 12.25" d x 3" h.

⚠ Does not work with Elevate Original Corner or Elevate Original Adjusta.

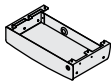

Drawer – Zido 4.5" h

- Originally designed for the Zido family, this drawer comes in Cool Grey (CG), which does not match other Elevate Original colors.
- The back of this locking drawer features a grommeted cord pass-through for power and network cables.
- Interior measurements are 19" w x 10" d x 3" h.

⚠ Does not work with Elevate Original Corner or Elevate Original Adjusta.

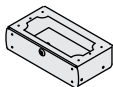

Drawer – Shallow 6" h

- This locking metal drawer measures just 8.5" deep.
- Interior dimensions are 14.75" w x 8.25" d x 5.75" h.

⚠ Does not work with Elevate Corner or Elevate Adjusta.

Cool Grey (CG)



Drawer – Large 6" h

- Interior measurements for this locking 6" Drawer are 13.25" w x 16.25" d x 6" h. Comes with 1 drawer divider.

⚠ Does not work with Elevate Corner or Elevate Adjusta.

FileAround

- Full-extension glides put everything in easy reach. Two locking casters keep unit in place when drawers are pulled out, and the fifth caster under the file drawer prevents the unit from tipping when drawers are fully extended.
- Holds up to 150 lbs. of distributed weight overall: up to 50 lbs. on top, up to 50 lbs. in the 6" drawer, and up to 75 lbs. in the 11" drawer.



PRODUCT	Weight Capacity	Locking	Width	Depth	Height	Weight	Part #	Price
Drawer - Small 3" h	15 lbs.	No	13"	12.5"	3.25"	7 lbs.	413zz	\$99.95
Drawer - Zido 4.5" h	15 lbs.	Yes	20.5"	11.25"	4.5"	13 lbs.	ZDRCG	\$169.95
Drawer - Shallow 6" h	20 lbs.	Yes	17.25"	8.25"	6.25"	12 lbs.	824zz	\$159.95
Drawer - Large 6" h	20 lbs.	Yes	13.5"	17.5"	6.5"	20 lbs.	275zz	\$249.95
FileAround	150 lbs.	Yes	15.5"	18.5"	21.5"	60 lbs.	510zz	\$299.95*

COLOR CHOICES

Select your product colors from the following swatches. Replace "zz" with a 2-letter Metal Code and "xx" with a 2-letter Laminate Code.



Metal Colors (zz)



Laminate Color (BK)

ELLIPTICAL TRAINER

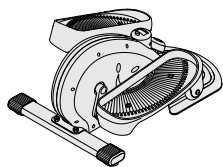

- Keep moving at your desk – without leaving your space or interrupting your work. Slide your feet into this Elliptical Trainer and start stepping. Move forward, backward, and even pause as you set your own pace.
- Use sitting or standing. Portable unit even tucks out of the way when not in use.
- Turn the Tension Knob to increase or decrease the resistance and set the intensity level.
- Electronic fitness monitor displays the number of strides per minute, the total number of strides, exercise time, and calories burned.
- Footprint is a space-saving 12" wide, 20" deep. Weight on this product should not exceed 250 lbs.
- Comes in Black with Silver accents. Ninety-day warranty against manufacturing defects.

PRODUCT	Width	Depth	Weight	Part #	Price
Elliptical Trainer	12"	20"	24 lbs.	MVELLBK	\$119.95*

FLAT PANEL MONITOR SOLUTIONS

Lots of choices for your flat panel monitor! Pick the features you need. **Note: all mounting options conform to VESA 75mm and 100mm mounting standards.** If you need a different standard or would like to discuss additional monitor solutions that we have available, give us a call.

Flat Panel Monitor Arm

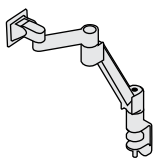

- These steel arms have a vertical travel range of 16" and rotate 360°. Travel range depends on the size of your monitor.
- Mount with either a C-clamp to the edge of your Table or drill through a shelf for added security. Clamp opens a maximum of 2" and requires 3.5" of vertical clearance below the shelf.
- The Single Arms extend up to 22" from their mounting point.
- The Single Extra Heavy-duty Arm comes with a 100mm and a 100x200mm VESA plate.
- Ten-year warranty against manufacturing defects.
- The Single-Standard and Single-Super Arms are available in Black (BK) and Silver Metallic (SM). Single-Light, Single Extra Heavy-duty, and Duty-Standard Arms are available in Black (BK).

PRODUCT	Supports Monitors Weighing	Weight	Part #	Price
Single - Standard	7.5-25 lbs.	20 lbs.	LCDxx	\$239*
Single - Super	13.5-44 lbs.	20 lbs.	LCD2xx	\$289*
Single - Extra Heavy-duty	36-69 lbs.	25 lbs.	LCDXBK	\$1,367
Single - Light	2-13.5 lbs.	20 lbs.	770BK	\$269.95*

 QuickShip available for Standard and Super arms only.

Flat Panel Monitor Mount



SINGLE MONITOR

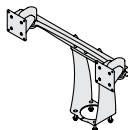

DUAL MONITOR

- Secure your flat panel monitor to your Table with this metal swivel-head mount on 13" high stand.
- Choose single or dual-monitor versions. The single-monitor version supports up to 22 lbs. The dual version supports a total of 22 lbs. and two monitors up to 17" across.
- Mount base is 4.5"w x 4.5"d.
- Available in Black (BK) or Silver Metallic (SM).
- Install by drilling through the shelf and securing with four bolts. Drill required for installation. 

PRODUCT	Weight	Part #	Price
Single Monitor	7 lbs.	615zz	\$219.95
Dual Monitor	12 lbs.	617zz	\$319.95

FOOTREST



- Elevate your feet with this simple footrest and alleviate pressure on your lower back. Rocking motion keeps your lower legs and feet moving while seated.
- Non-skid pads on the surface keep your feet in place.
- Measures 16.75"w x 12.25"d x 4.5"h.
- Comes in Black.

PRODUCT	Weight	Part #	Price
Footrest	5 lbs.	729BK	\$89.95*



KEYBOARD SOLUTIONS

Whether you're looking for ergonomics or just convenience, finding the right Keyboard Solution can make a world of difference in your workstation. And we offer lots of choices. Sometimes the differences between the caddies are subtle, so feel free to call us to find the right solution for you.

Keyboard and Mouse Caddy, Style B – Super

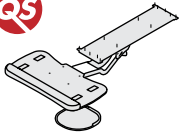

- Caddy moves in and out, up and down, tilts 15° positive and 15° negative, and swivels 360°. Movement ranges from even with your work surface to 6" below.
- Swing-out mouse surface pivots out when it's needed and hides away when it's not.
- Made of steel and phenolic with an integrated foam wrist rest.
- Surfaces are neutral granite color.
- Requires 18.5" mounting depth. Drill required for installation. **F**

PRODUCT	Width	Weight	Part #	Price
Keyboard and Mouse Caddy, Style B	19.5"	7 lbs.	UKMCKB	\$239.95

⚠ Does not work with Elevate Original Adjusta.

Keyboard and Mouse Caddy, Style C – Elevate

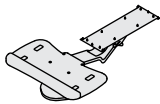

- Caddy moves in and out on an 18.5" track, up and down from 2" above your work surface to 6" below, tilts 15° positive and 15° negative, and swivels 360°.
- Swing-out mouse surface pivots out when it's needed and hides away when it's not.
- Made of steel and phenolic with an integrated foam wrist rest. Surfaces are neutral granite color.
- Requires 18.5" mounting depth. Drill required for installation. **F**

PRODUCT	Width	Weight	Part #	Price
Keyboard and Mouse Caddy, Style C	19.5"	13 lbs.	159BK	\$319.95

⚠ Does not work with Elevate Original Adjusta.

Keyboard Drawer – Basic

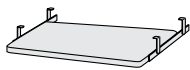

- Laminated wood surface moves in and out. Extends 10" in front of the Unit. Assemble the Drawer to fit 3-4" below your large shelf.
- Want to add a mouse surface to your Keyboard Drawer? Consider the Mouse Shelf, Swing-out (Part # 687BK, see Elevate: Accessories).
- Available in Black (BK) or Fog (FG), which matches the Light Grey (LG) laminate color of the Elevate.
- Drill required for installation. **F**

PRODUCT	Width	Depth	Weight	Part #	Price
20" wide Keyboard Drawer – Basic	20"	11"	8 lbs.	20xx	\$119.95
30" wide Keyboard Drawer – Basic	30"	11"	15 lbs.	30xx	\$129.95

⚠ Does not work with Elevate Original Corner or Adjusta. The 30" Keyboard Drawer does not work with the 36" wide Elevate Original Single Surface.

Keyboard Drawer – Zido

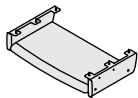

- Originally designed for the Zido family, this drawer comes in Cool Grey (CG), which does not match other Elevate Original colors.
- Keyboard surface pulls out on full-extension glides. The wood keyboard surface is wrapped in a high-durability Kydex®-brand thermoplastic laminate that resists cracking and chipping.
- Drill required for installation. **F**

PRODUCT	Width	Depth	Weight	Part #	Price
Keyboard Drawer – Zido	19"	11"	12 lbs.	ZKD20CG	\$159.95

⚠ Does not work with Elevate Original Corner or Elevate Original Adjusta.

COLOR CHOICES

Select your product colors from the following swatches. Replace "zz" with a 2-letter Metal Code and "xx" with a 2-letter Laminate Code.

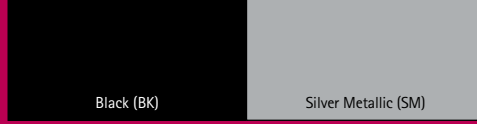

Metal Colors (zz)



Laminate Color (BK)

MOUSE SOLUTIONS

Mouse Shelf – Swing-out



- Made of heavy-duty phenolic in neutral granite finish. Attaches to wood surfaces. Drill required for installation.

PRODUCT	Width	Depth	Weight	Part #	Price
Mouse Shelf – Swing-out	8"	9"	2 lbs.	687BK	\$69.95

Mouse Holder



- Store your mouse in this handy holder on the side or front of your station. Especially useful in mobile applications where you want to protect your mouse from falling off the work surface.
- Available in Silver Metallic (SM).
- All-metal holder attaches to any wood surface with two wood screws. Mounting bracket is 5" w x 1" d. Drill required for installation.

PRODUCT	Width	Depth	Height	Weight	Part #	Price
Mouse Holder	5.75"	4"	5"	2 lbs.	ZMHSM	\$39.95

POWER SOLUTIONS

Plug all of your electrical cords into a single strip to keep them organized and accessible. Choose the mounting option and features that are right for you.

Power Bar

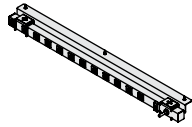

- Rated at 15 amps, 120 Volts. 2" spacing allows AC/DC adapters at each receptacle.
- Comes with 12' cord, on/off switch, on/off indicator light, and circuit breaker reset button.
- Mount under any surface to face forward, down or back; bar is easy to reposition. Drill required for installation.
- One-year warranty against manufacturing defects.

PRODUCT	Width	Depth	Height	Weight	Part #	Price
12 Receptacles	36"	2"	3"	8 lbs.	PBA12SM	\$99.95*
16 Receptacles	48"	2"	3"	12 lbs.	PBA16SM	\$119.95*

Power Bar does not provide surge protection. Does not work with 36" wide Elevate Original Single Surface.

Surge Protectors

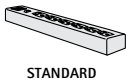

STANDARD

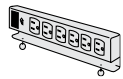

CLAMP-ON

- These UL-listed surge suppressors are 12" long, have 6 outlets and are rated at 15 amps, 120 Volts. Come with on/off switch, on/off indicator light, and circuit breaker reset button.
- Surge Protector – Standard comes in Black (BK) and attaches under a shelf with integrated mounting hardware or slips into the cable trough.
- Surge Protector – Clamp-on comes in Black (BK) with the clamp available in Black (BK) or Silver Metallic (SM). The C-clamp mounts onto the edge of any shelf with two threaded knobs.
- One-year warranty against manufacturing defects.

PRODUCT	Cord Length	Depth	Weight	Part #	Price
Surge Protector – Standard	15'	2.5"	2 lbs.	520BK	\$84.95
Surge Protector – Clamp-on	15'	2.5"	5 lbs.	BPSzz/BK	\$129.95

PROBE HOLDERS

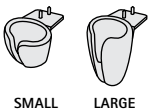

SMALL LARGE

- Originally designed for the Zido family, these holders come in grey and light green with Cool Grey (CG) brackets, which do not match other Convo colors.
- Brackets measure 1.5" wide x 2.5" deep and attach to the bottom of any wood surface with 2 screws. Cushioned cups are open on the bottom and snap into place. Drill required for installation.

PRODUCT	Width	Depth	Height	Weight	Part #	Price
Probe Holder, Small	2.5"	3.5"	2.5"	1 lb.	ZGCSCG	\$44.95
Probe Holder, Large	2.5"	3.5"	4.5"	1 lb.	ZGCLCG	\$49.95

Quick Ship is available for the Large Probe Holder only.

Most of our customers attest to our great assembly instructions and the tools we send to put your units together. Our aim is to make assembly as easy as possible.

SCANNER BRACKET



- Keep your barcode scanner right at hand with this metal bracket. Inside opening on bracket is 1.5"w x 2"d.
- Available in Silver Metallic (SM).
- Installs on any wood surface with two screws. Drill required for installation. 

PRODUCT	Width	Depth	Height	Weight	Part #	Price
Scanner Bracket	2.25"	5.25"	3.5"	1 lb.	886SM	\$34.95

SECURITY CABLE, 36"



- Protect laptops and hard drives from theft. Using its adapter, the lock attaches to the back of your laptop or hard drive and the cable loops around the cable trough or brackets of your workstation.
- Comes with the cable, lock, and two keys.

PRODUCT	Length	Weight	Part #	Price
Security Cable, 36"	36"	2 lbs.	960SM	\$99.95*

SHELVES

Shelf - Equipment Base

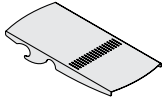

- This metal Shelf hooks onto the horizontal base tubes of your Elevate and provides a safe and sturdy place for your hardware. Comes with a strap and buckle to hold your equipment snugly.
- When the Single Surface and Adjusta are at their lowest position, there is 13" clearance above this Shelf. When the Corner is at its lowest position, there is 12" clearance above this shelf.
- Available in Black (BK) or Silver Metallic (SM) metal.

PRODUCT	Width	Depth	Weight	Part #	Price
Equipment Base Shelf	10"	22"	8 lbs.	416zz	\$99.95